

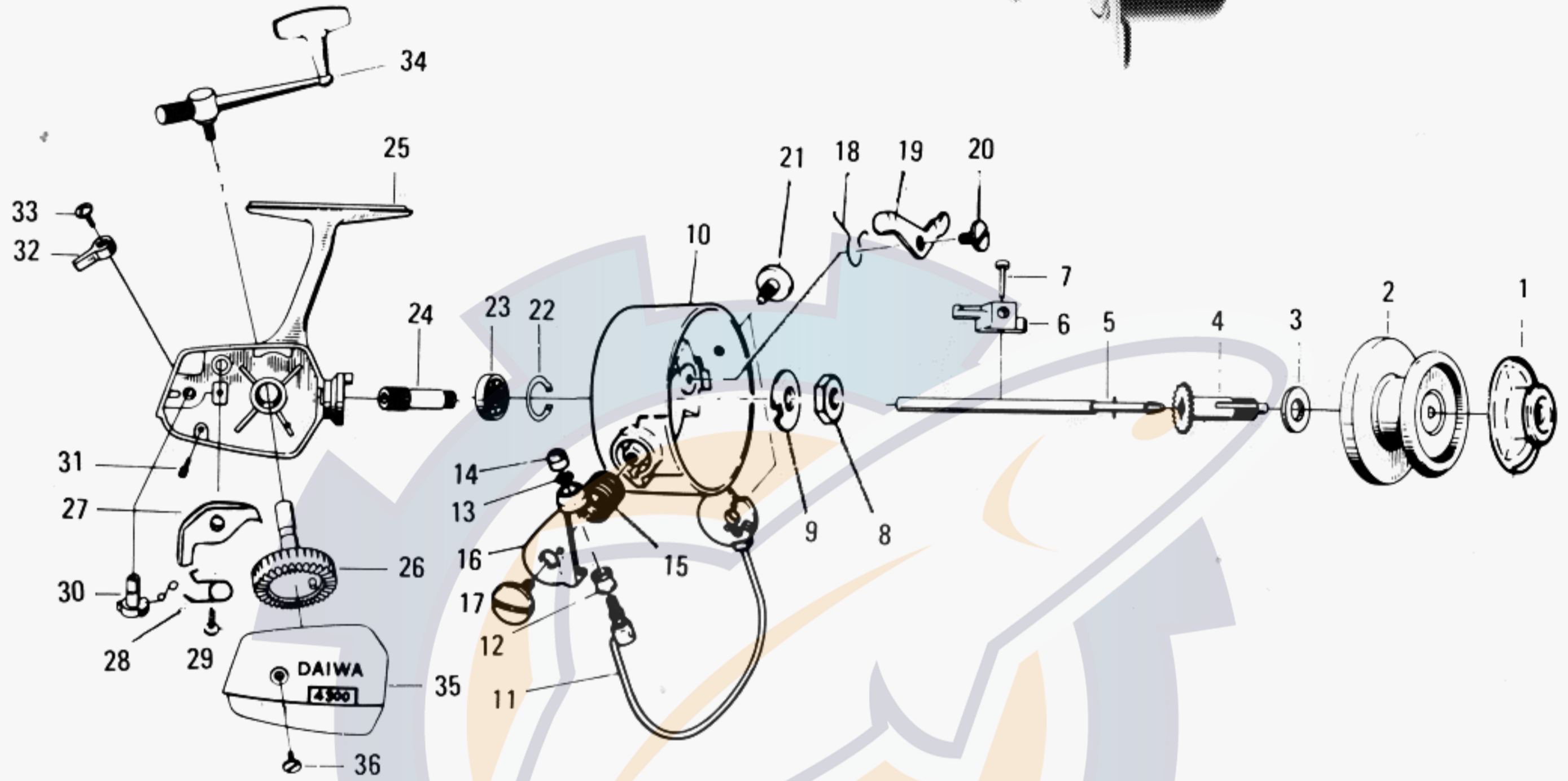

**DAIWA**  
CORPORATION CALIF

SPINNING REEL

**4300**  
**4300R**

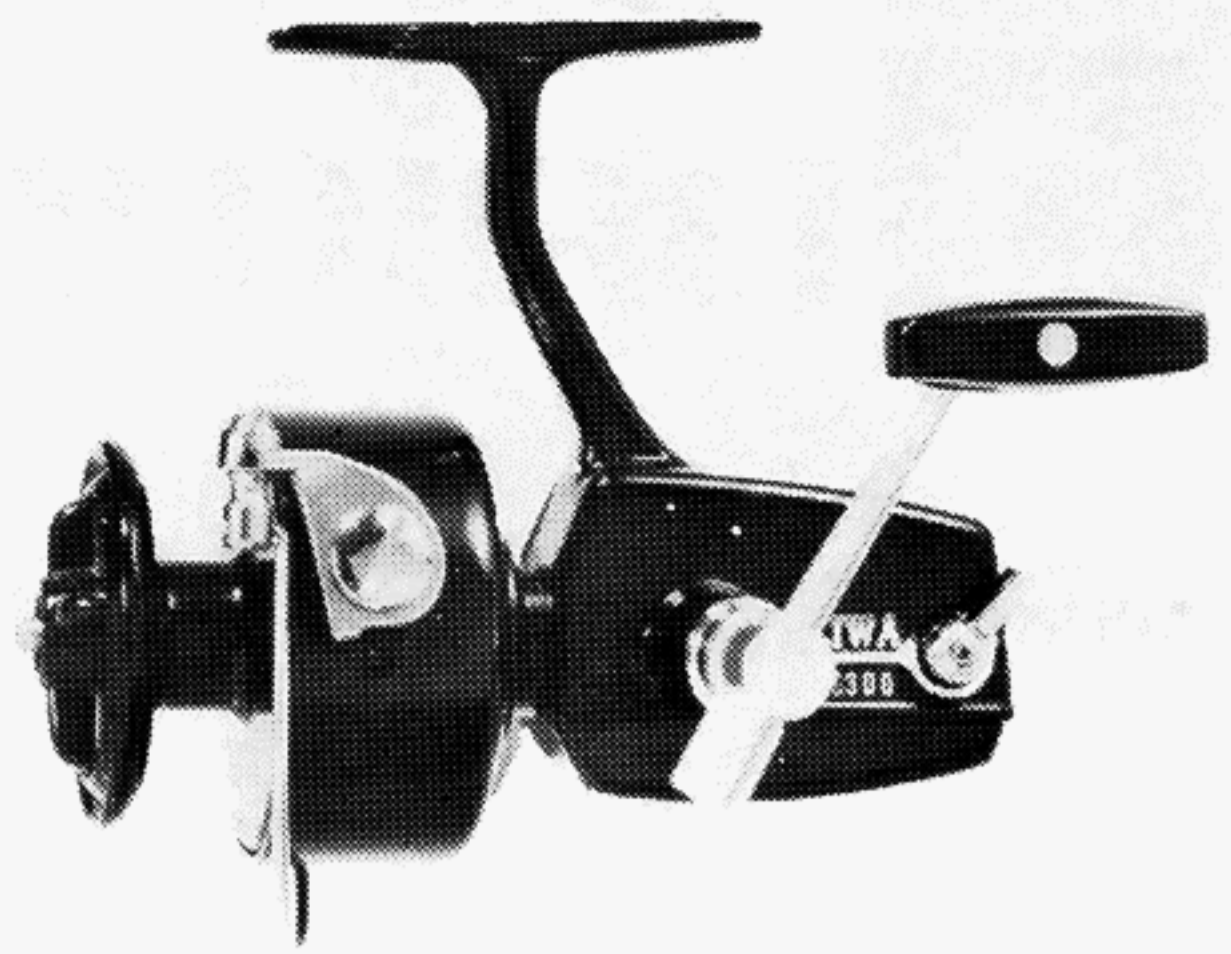

LINE CAPACITY: 250 YDS., 10 LB. TEST

Key No.	Parts No.	Parts Name	Key No.	Parts No.	Parts Name	Key No.	Parts No.	Parts Name
1	007 8401 (A00784)	Drag knob	18	140 6231 (1462b-2)	Bail kick lever spring	35	061 5531 (06155)	Body cover
2	008 6821 (A00868)	Spool assembly	19	570 5321 (5753)	Bail kick lever	36	361 6011 (36160)	Body cover screw
3	373 1502 (37315)	Spool washer	20	361 1511 (36115a)	Bail kick lever screw	<b>For 4300R only</b>		
4	007 8541 (A00785)	Shaft metal	21	351 6401 (35164)	Bail holder screw	6	480 5411 (4854)	Oscillating slider
5	002 8052 (A00280a)	Main shaft	22	320 2901 (3229)	Ball bearing retaining ring	10	201 1041 (20110)	Rotor
6	480 5021 (4850a)	Oscillating slider	23	631 6901 (63169)	Ball bearing	11	008 8701 (A00887)	Bail
7	120 8711 (1287a)	Oscillating slider pin	24	401 4011 (40140)	Pinion	15	141 1311 (14113)	Bail spring
8	340 6601 (3466)	Rotor nut	25	191 6621 (19166)	Body	16	230 8201 (2382)	Arm lever
9	371 3101 (37131)	Rotor retaining washer	26	411 7311 (41173)	Drive gear	17	361 6601 (36166)	Arm lever screw
10	201 0831 (20108)	Rotor	27	110 7511 (1175)	Anti-reverse claw	18	140 5031 (1450)	Bail kick lever spring
11	007 6201 (A00762)	Bail	28	142 5501 (14255)	Anti-reverse claw spring	19	570 6901 (5769)	Bail kick lever
12	250 1901 (2519)	Line roller	29	351 2001 (35120)	Anti-reverse claw screw	25	191 6521 (19165)	Body
13	160 0121 (1601b)	Bail washer	30	002 7421 (A00274)	Anti-reverse cam	26	411 7312 (41173)	Drive gear
14	341 0801 (34108)	Bail nut	31	351 4311 (35143)	Anti-reverse cam screw	28	142 7501 (14275)	Anti-reverse claw spring
15	140 9221 (1492a)	Bail spring	32	540 2221 (5422)	Anti-reverse lever	30	003 5021 (A00350)	Anti-reverse cam
16	230 8301 (2383)	Arm lever	33	350 1931 (3519)	Anti-reverse lever screw	34	008 6702 (A00867)	Handle
17	361 6611 (36166)	Arm lever screw	34	008 6701 (A00867)	Handle	35	061 5631 (06156)	Body cover